



For Lease

317 NE 31st Street
Oklahoma City, OK 73105

Total SF: 68,900
Office SF: 8,772



Distribution Warehouse

For Lease or Sale - \$2.2 Million/ \$3.00 NNN

Property Information:

- 68,900 sf Total
 - 8,772 sf Office Available
 - 16,513 sf 35°-38°F Cold Rms
 - 8,424 sf 70° Temp. Contrlled Rm
 - 24,237 sf Open Storage
- On Site Truck Maintenance Building - 5,100 sf
- Adjacent 2 Acres Additional Paved Parking
- 18' Clear Height
- 3 - Dock High Doors
- 3 - Drive-in Doors
- Construction Type - Brick
- Keycard security access
- Exterior lighting
- HVAC in Office
- Ample parking
- I-2 Zoning Moderate Industrial
- Water - City of OKC
- Sewer - City of OKC
- Gas - ONG
- Electrical - OG&E
- Sprinklered

Please Contact: Stephen Tanenbaum
Office: (405) 524-8484 ext. 104
Cell: (405) 996-0302
4228 N. Santa Fe, Oklahoma City, OK 73118
stanenbaum@ggdevco.com
www.gardnertanenbaumgroup.com



For Lease

317 NE 31st Street
Oklahoma City, OK 73105

Total SF: 68,900
Office SF: 8,772



Office Area



Office Area



Office Area



Warehouse Area



Warehouse Area



Metal Building



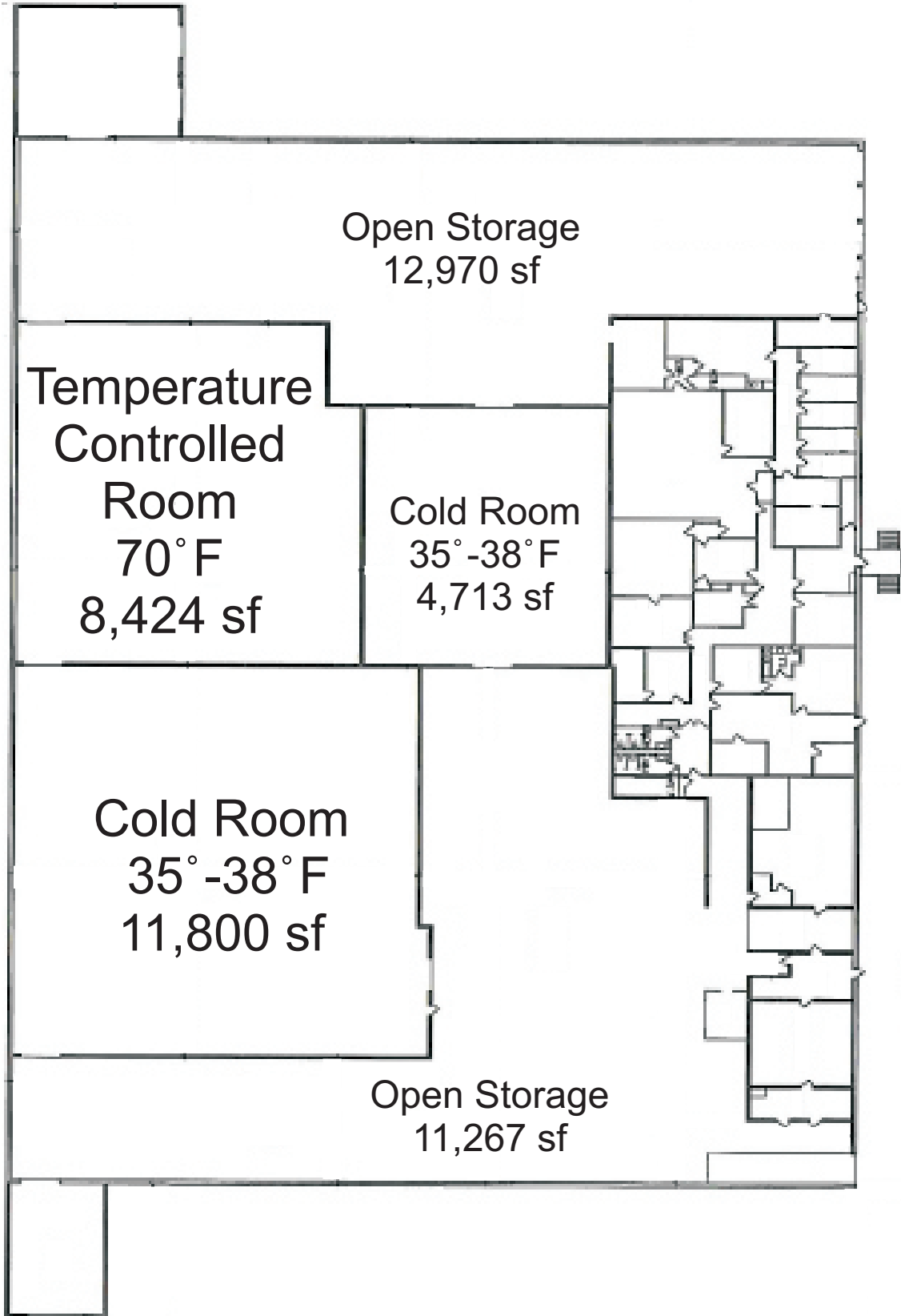

68,900 sf Total



For Lease

317 N.E. 31st St
Oklahoma City, OK 73105

Total SF: 68,900
Office SF: 8,722

